

Pax Low Profile Conveyors

- Extremely low profile
 - Only 3/8" from Bolster to top of Belt
 - Requires only 1.25" to 2.5" total clearance
- Built to survive a Stamping Environment
 - Resistant to Die Lube
 - Conveyor design protects and maximizes belt life.
 - Highly durable components.
 - Light weight modular design
- Pax Support & Customization

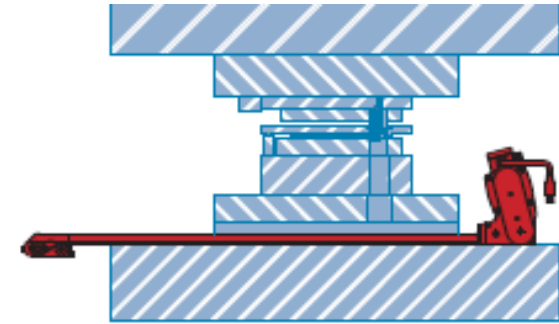

The Pax Low Profile Conveyor requires only 2-1/2" clearance between die and bolster.



Standard Drive

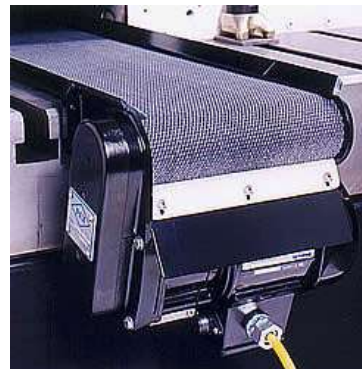

Inverted Drive



Extended Drive



Right Angle Drive

Pax Low Profile Conveyors

Low Profile



OPTIONAL Flush Mount Tension End



Pax Low Profile Conveyors

Resistant to Die Lube



Pax designed control box includes gasket seals

Critical areas are sealed to prevent lubrication from entering

Pax utilizes Industrial Motors and seals them against die lubrication



Pax Low Profile Conveyors

Conveyor design Protects Belt

Standard belt is woven polyester belt with stainless steel lacing

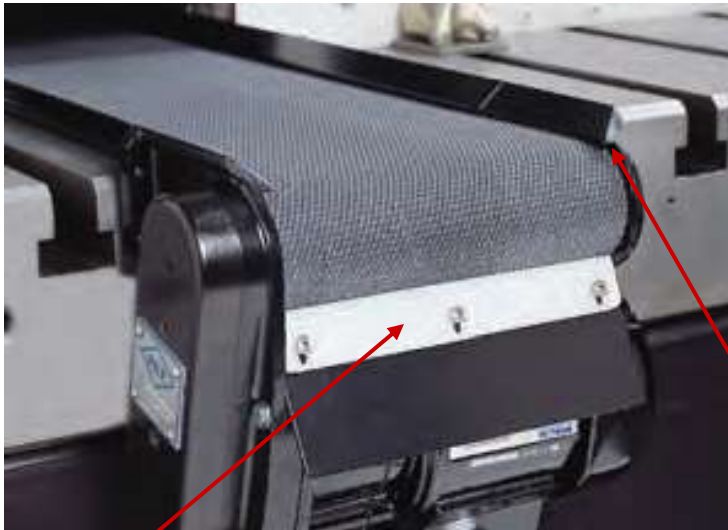

Spring applied End Wiper rides against belt to remove small particles and excess lubrication. Wiper also protects against possible pinch point.

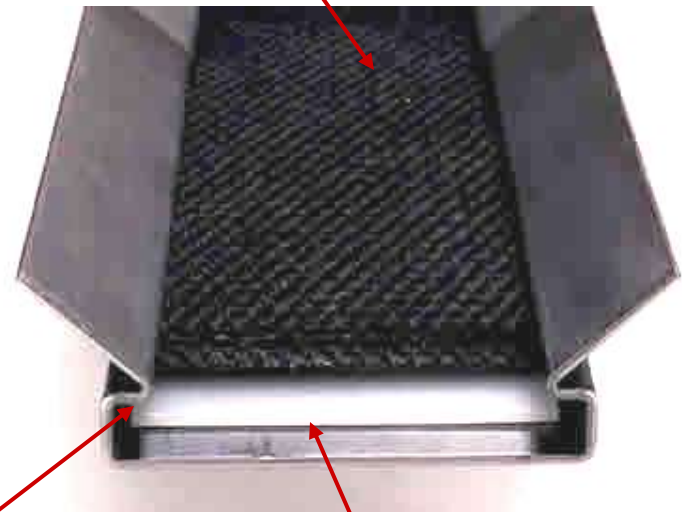

Belt edges protected by formed tray.

Belt rides on PVC strip to reduce wear & friction.

Pax Low Profile Conveyors

Durable Construction



Heat Treated
Cast Aluminum



Formed Tray
provides strength



PVC strip reduces
belt friction



Hardened, anodized alum
drive and tension pulleys run
on Hardened Steel shafts

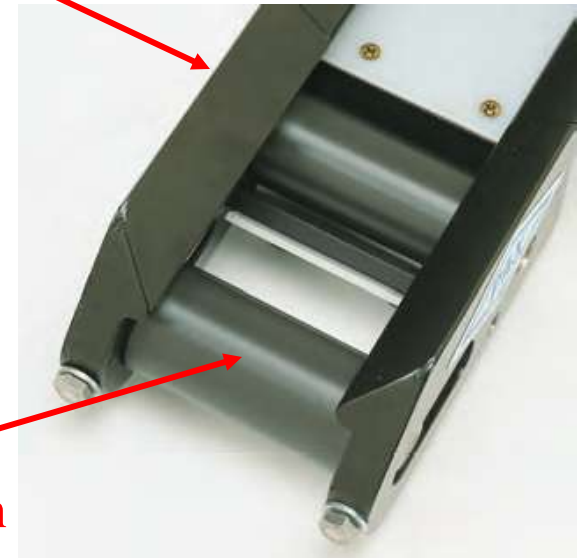

Pax Low Profile Conveyors

Optional end & side wipers can keep scrap from getting below belt

End Wiper

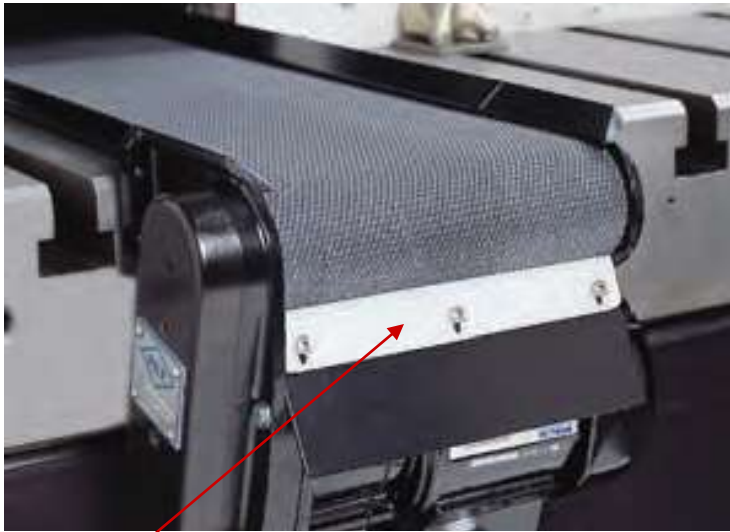

Spring applied End Wiper rides against belt to remove scrap.

Side Wipers

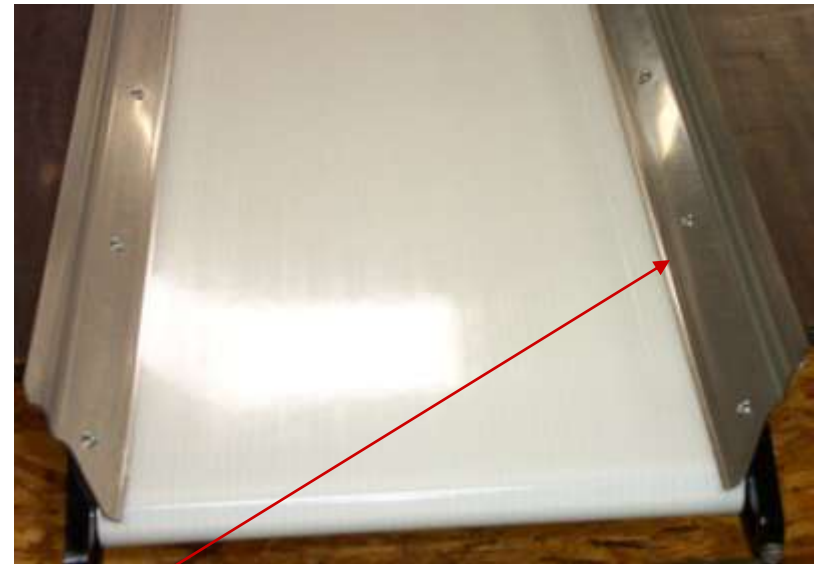

**Special side wipers can be designed with virtually zero clearance to belt to prevent scrap from getting below belt.
Note, a u-style tray & an endless belt are utilized with this option.**

Pax Low Profile Conveyors

2 Ply Monofilament, Polyurethane Belt

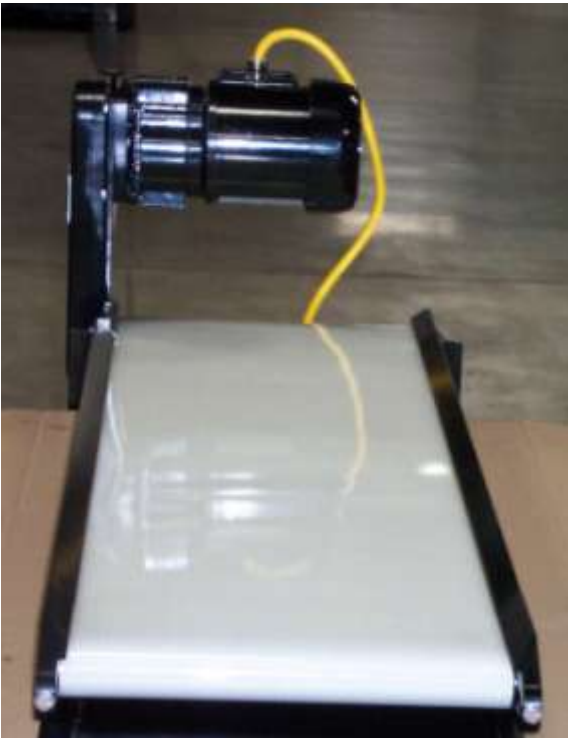

The smooth, laceless belt will provide a continuous, smooth surface for the end wiper to continuously push against (wiping scrap from the belt)

Belt Construction

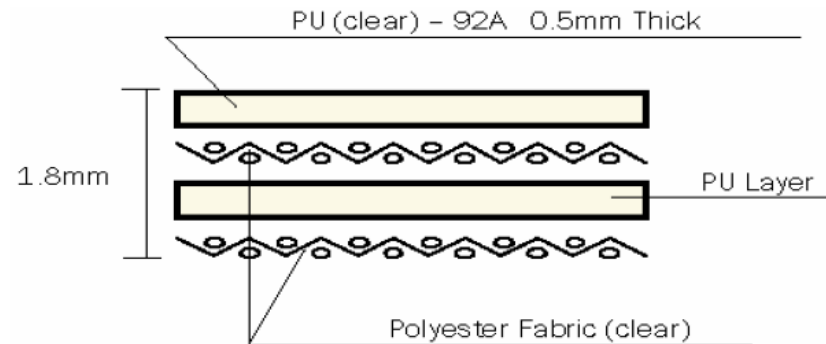

The quoted Pax conveyor includes a 2 ply, monofilament, oil resistant belt. The belt is comprised of 2 layers of clear polyurethane and 2 layers of urethane coated polyester material, which combine for a total thickness of 1.8 mm. This belt design last approximately 5 times longer than typical polyester belts.

Pax Low Profile Conveyors

Optional Stop Belt Sensor

The Stopped Belt Sensor is used in conjunction with the press control die protection circuit. The press control can stop the press when the signal it is receiving from the stopped belt sensor indicates that the belt has stopped. This prevents or minimizes any damage to your die or conveyor that would have been caused by a stopped belt.

Sensor monitors movement of idler pulley



Cable plugs into sensor and can be tied into press stop protection.



Sensor wheel rides on idler pulley, which will stop if belt stops (even if motor is still running)

Casting containing sensor mounts over idler pulley wheel

Pax Low Profile Conveyors

Pax maintains stock for all standard conveyor components.

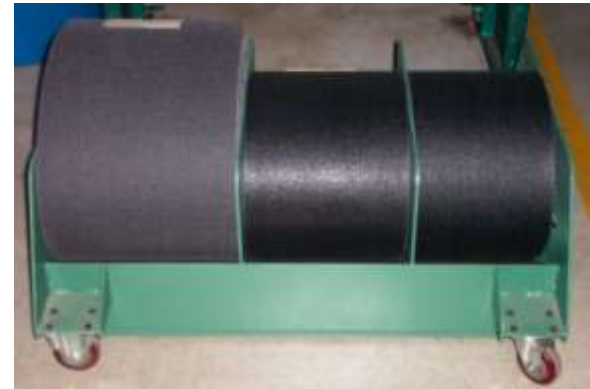

Pax creates custom designs as required to best meet customer needs

CONVEYOR WIDTH	A
4"	6.56"
5"	5.56"
6"	4.56"
7"	3.56"
8"	2.56"
9"	1.56"
10"	0.56"
11"	N/A
12"	N/A
14"	N/A
16"	N/A
18"	N/A
20"	N/A

PAX CONVEYOR WIDTH

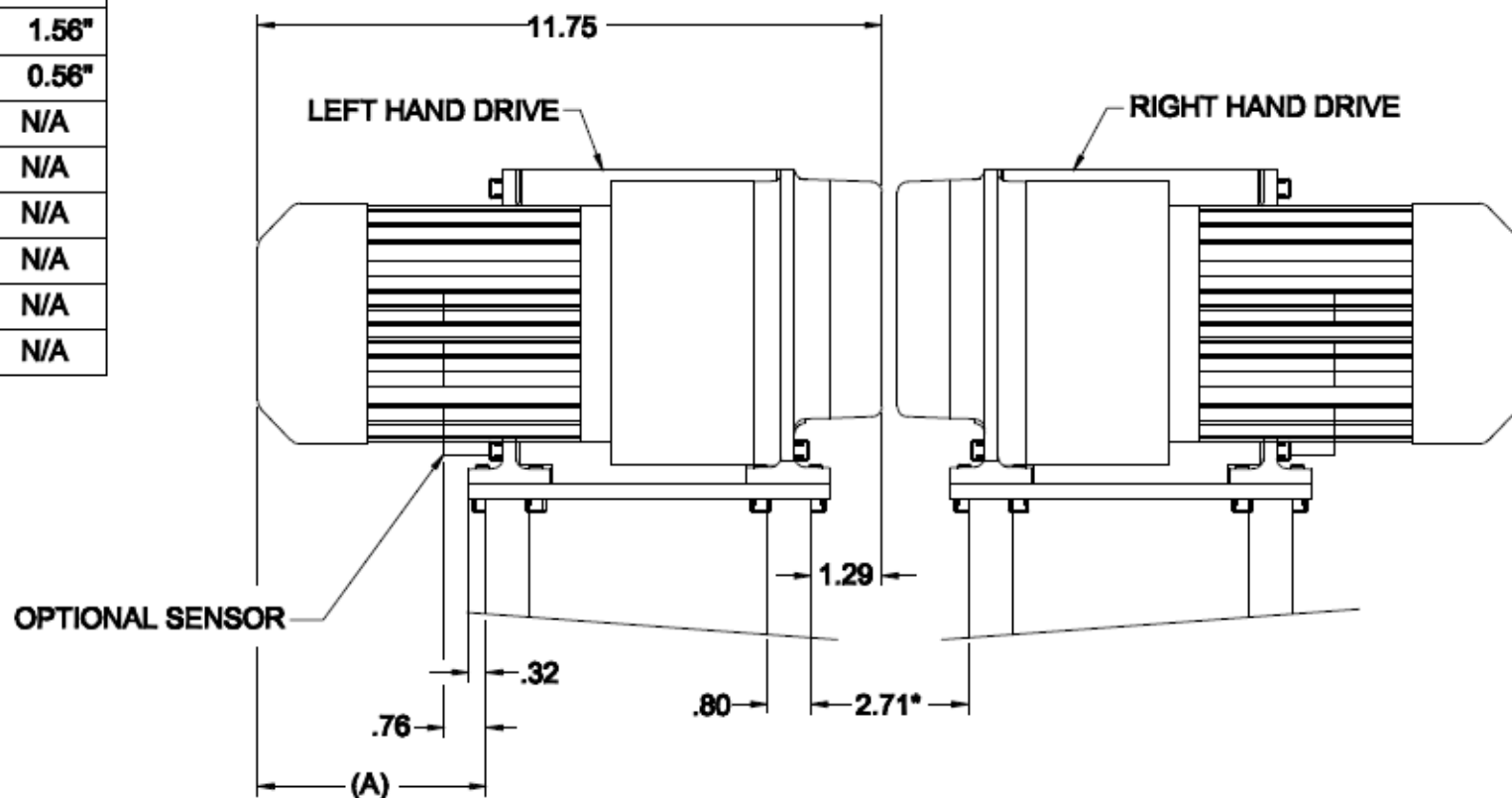

*DISTANCE BETWEEN TRAYS WITH .125 CLEARANCE BETWEEN ANY TWO OPPOSITE DRIVE CONVEYORS

Ref. Dimensions Std Drive Conveyor

PAX CONVEYOR SIZE SPECIFICATIONS

CONVEYOR WIDTH	A	B
4"	3.95"	2.35"
5"	4.95"	3.35"
6"	5.95"	4.35"
7"	6.95"	5.35"
8"	7.95"	6.35"
9"	8.95"	7.35"
10"	9.95"	8.35"
11"	10.95"	9.35"
12"	11.95"	10.35"
14"	13.95"	12.35"
16"	15.95"	14.35"
18"	17.95"	16.35"
20"	19.95"	18.35"

CONVEYOR LENGTH	C	D	E
4'	48"	56.00"	43.25"
5'	60"	68.00"	55.25"
6'	72"	80.00"	67.25"
7'	84"	92.00"	79.25"
8'	96"	104.00"	91.25"

CONVEYOR HEIGHT	F
BISON MOTOR	10.88"

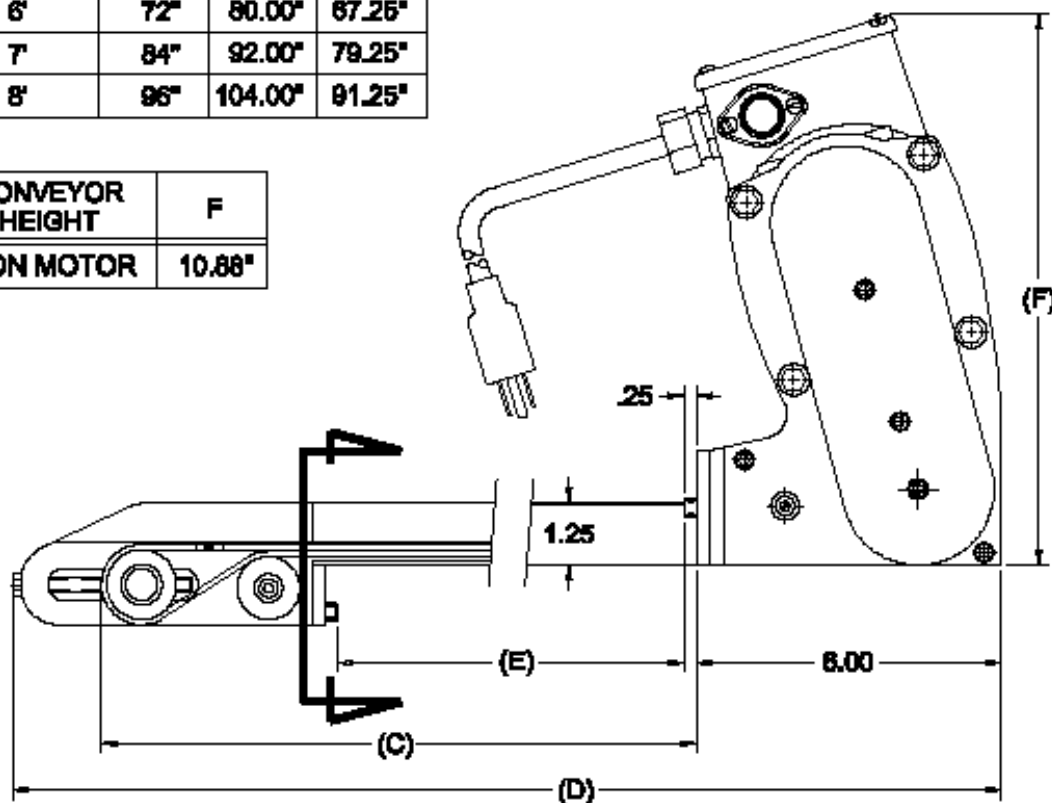
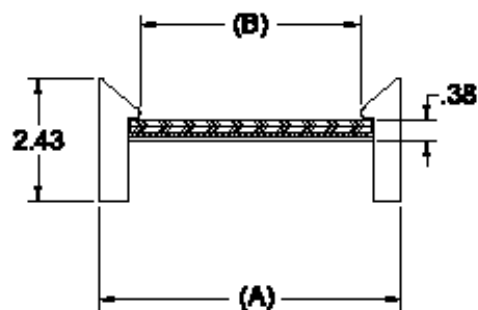

Pax Low Profile Conveyors

Inverted Drives



Inverted Drive with Flush Mount



20" Wide
Inverted Drive

Ref. Dimensions Inverted Drive

PAX CONVEYOR INVERTED DRIVE DIMENSIONS

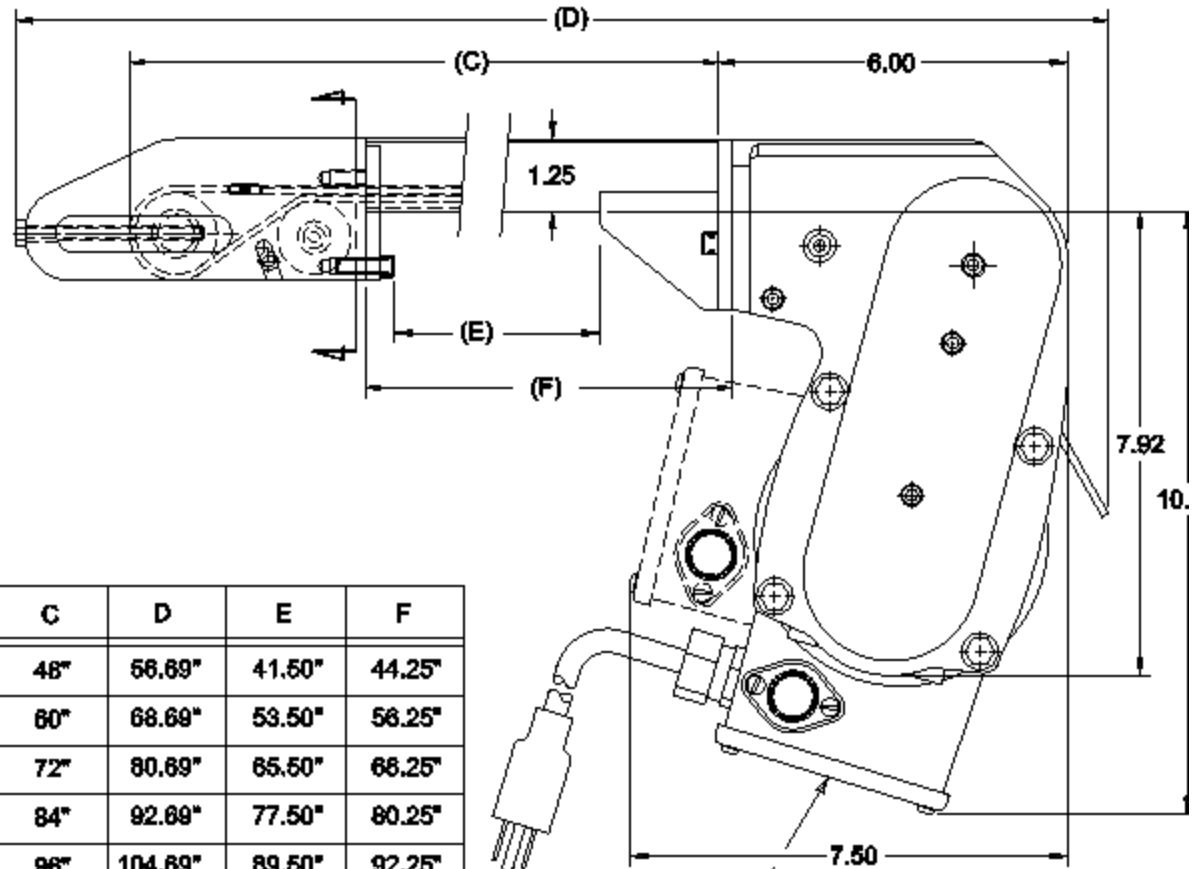
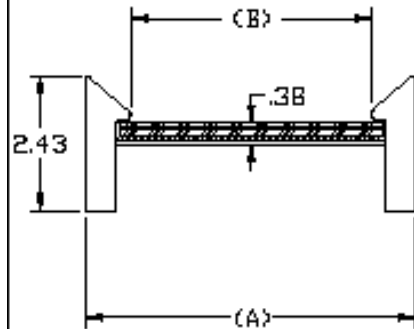

CONVEYOR WIDTH	A	B
4'	3.95'	2.35'
5'	4.95'	3.35'
6'	5.95'	4.35'
7'	6.95'	5.35'
8'	7.95'	6.35'
9'	8.95'	7.35'
10'	9.95'	8.35'
11'	10.95'	9.35'
12'	11.95'	10.35'
14'	13.95'	12.35'
16'	15.95'	14.35'
18'	17.95'	16.35'
20'	19.95'	18.35'

CONVEYOR LENGTH	C	D	E	F
4'	48"	56.69"	41.50"	44.25"
5'	60"	68.69"	53.50"	56.25"
6'	72"	80.69"	65.50"	68.25"
7'	84"	92.69"	77.50"	80.25"
8'	96"	104.69"	89.50"	92.25"

TERMINAL BOX CAN BE
ROTATED 90 DEG. CLOCKWISE
TO REDUCE OVERALL
HEIGHT AS SHOWN

NOTE: TRAVEL OF CONVEYED MATERIAL

Pax Low Profile Conveyors

Extended Top Drives

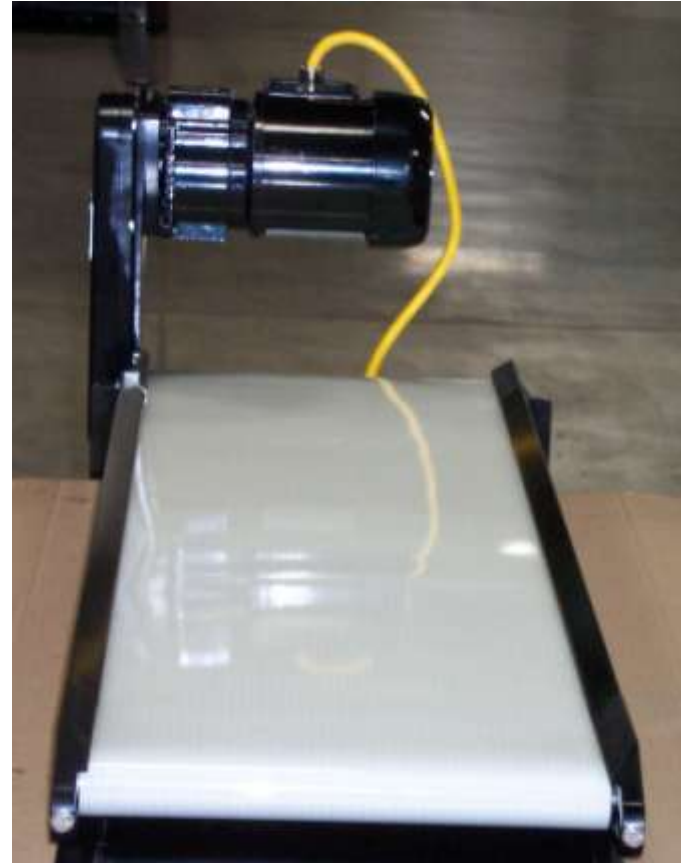
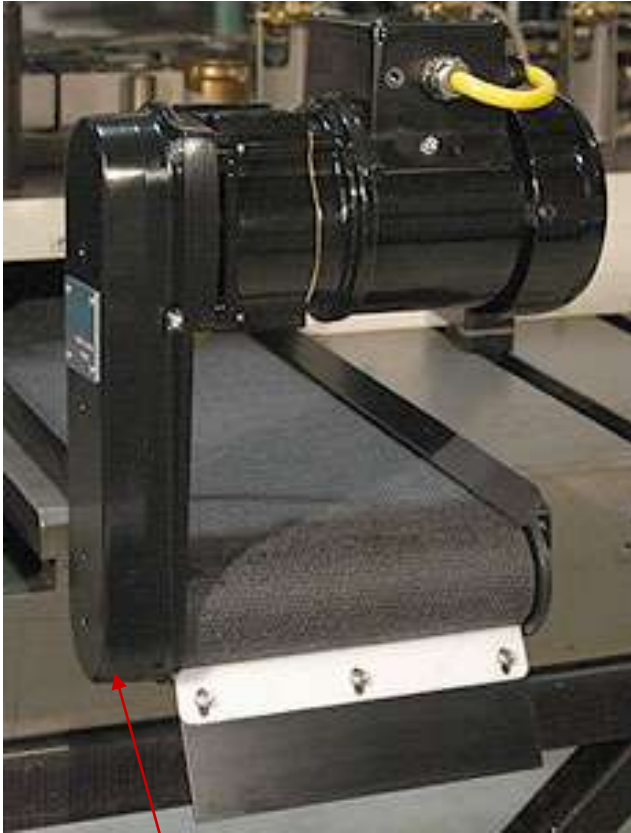

Note: Drive end extends below Tray (below bolster surface)

Pax Extended, Top Drive Conveyor

CONVEYOR WIDTH	A	B	CONVEYOR LENGTH	C	D	E	F
4"	3.95"	2.35"	4'	48"	56.75"	41.50"	44.25"
5"	4.95"	3.35"	5'	60"	68.75"	53.50"	56.25"
6"	5.95"	4.35"	6'	72"	80.75"	65.50"	68.25"
7"	6.95"	5.35"	7'	84"	92.75"	77.50"	80.25"
8"	7.95"	6.35"	8'	96"	104.75"	89.50"	92.25"
9"	8.95"	7.35"					
10"	9.95"	8.35"					
11"	10.95"	9.35"					
12"	11.95"	10.35"					
14"	13.95"	12.35"					
16"	15.95"	14.35"					
18"	17.95"	16.35"					
20"	19.95"	18.35"					

PAX CONVEYOR
EXTENDED TOP DRIVE

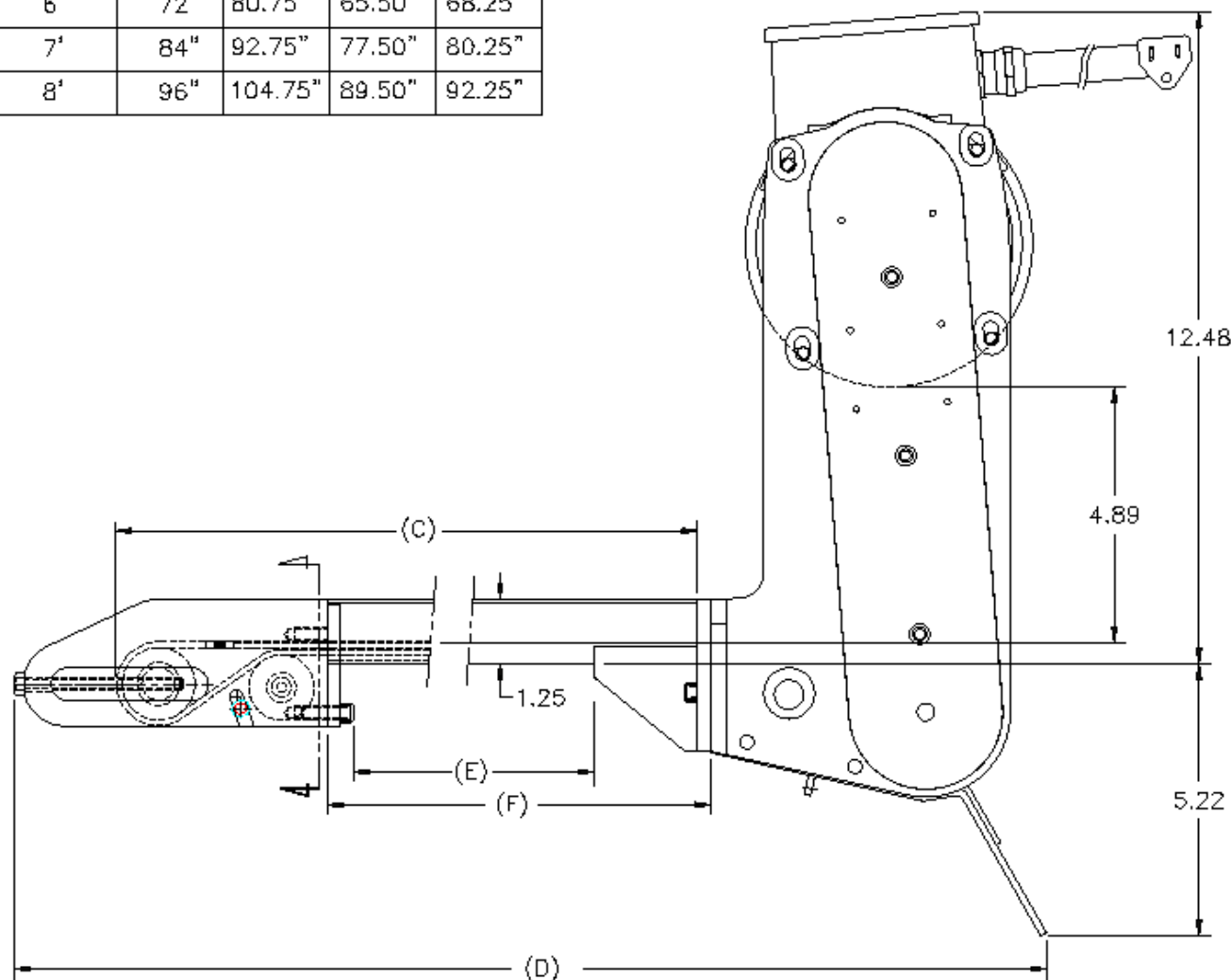
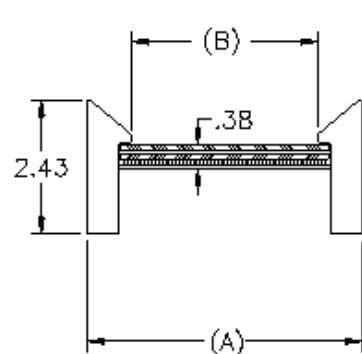

Pax Extended, Top Drive Conveyor with Flush Mount

CONVEYOR WIDTH	A	B	CONVEYOR LENGTH	C	D	E
4"	3.95"	2.35"	4'	55.75"	41.50"	44.25"
5"	4.95"	3.35"	5'	67.75"	53.50"	56.25"
6"	5.95"	4.35"	6'	79.75"	65.50"	68.25"
7"	6.95"	5.35"	7'	91.75"	77.50"	80.25"
8"	7.95"	6.35"	8'	103.75"	89.50"	92.25"
9"	8.95"	7.35"				
10"	9.95"	8.35"				
11"	10.95"	9.35"				
12"	11.95"	10.35"				
14"	13.95"	12.35"				
16"	15.95"	14.35"				
18"	17.95"	16.35"				
20"	19.95"	18.35"				

PAX CONVEYOR EXTENDED TOP DRIVE W/ FLUSH MOUNT TENSION END

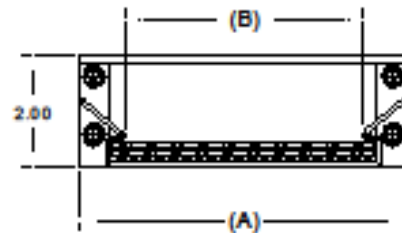
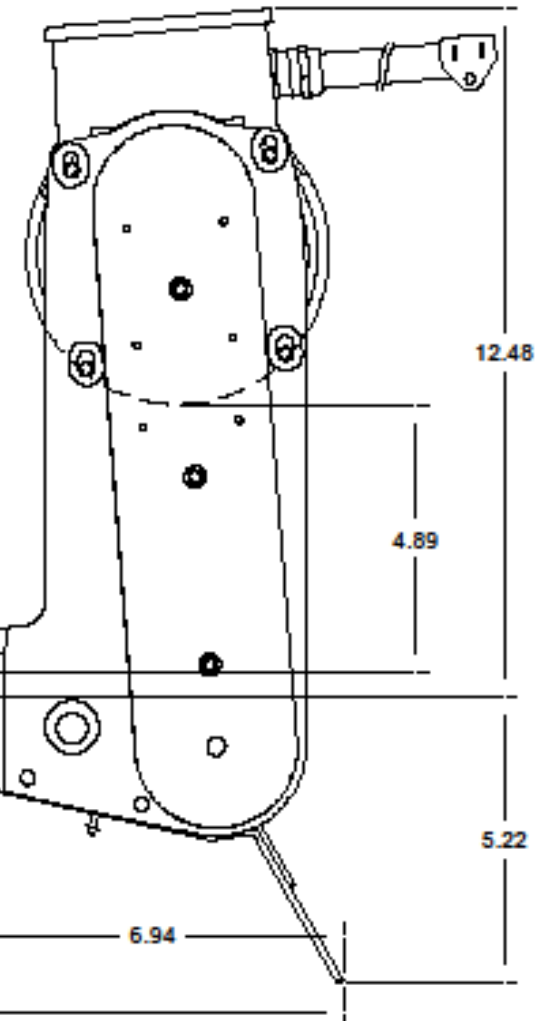

Pax Low Profile Conveyors

Right Angle Drives

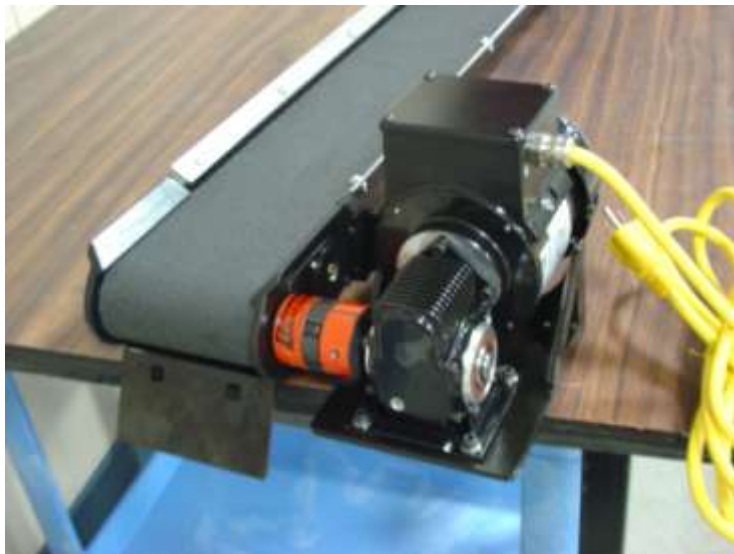
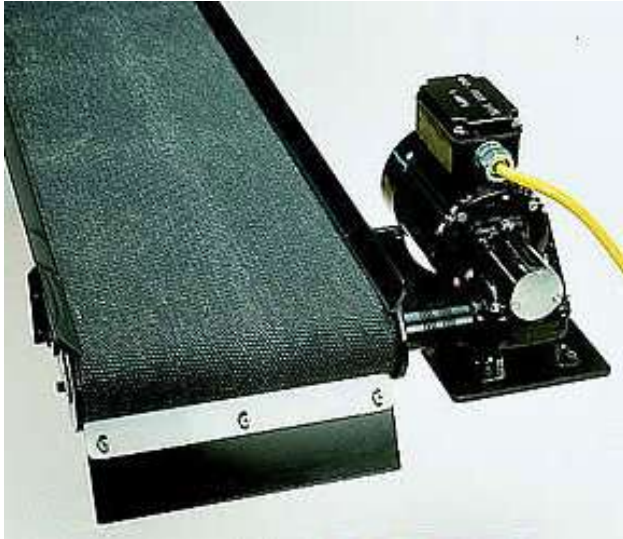

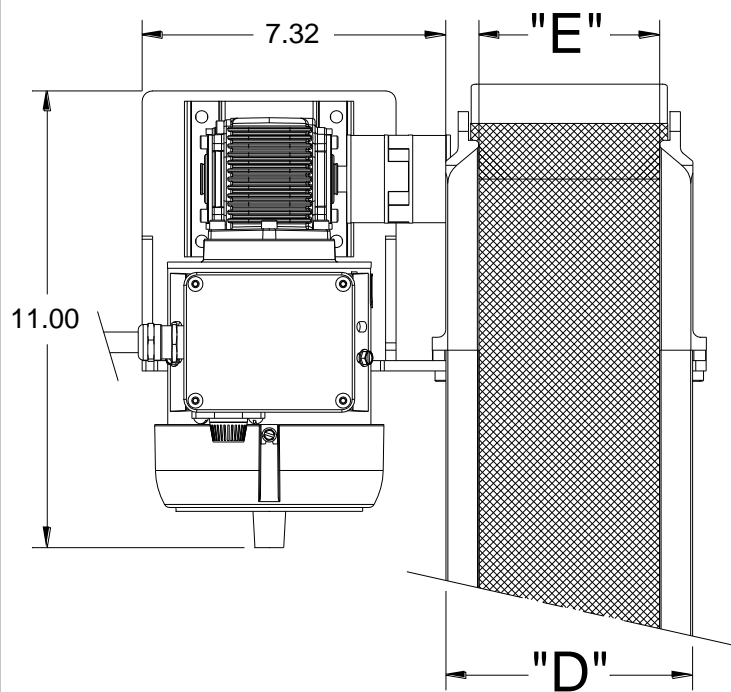

PAX RIGHT ANGLE CONVEYOR

CONVEYOR LENGTH	A	B	C
4'	48"	56.06"	43.00"
5'	60"	68.06"	55.00"
6'	72"	80.06"	67.00"
7'	84"	92.06"	79.00"
8'	96"	104.06"	91.00"

CONVEYOR WIDTH	D	E
4"	3.95"	2.35"
5"	4.95"	3.35"
6"	5.95"	4.35"
7"	6.95"	5.35"
8"	7.95"	6.35"
9"	8.95"	7.35"
10"	9.95"	8.35"
11"	10.95"	9.35"
12"	11.95"	10.35"
14"	13.95"	12.35"
16"	15.95"	14.35"
18"	17.95"	16.35"
20"	19.95"	18.35"

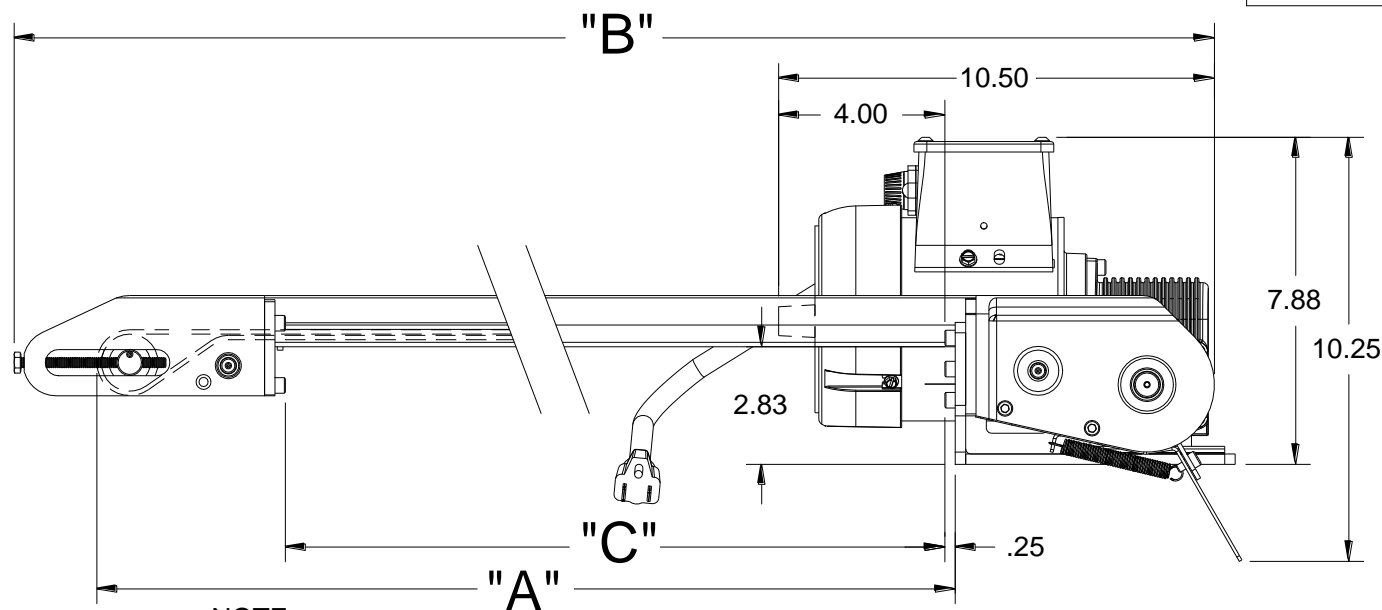

NOTE:
TRAVEL OF CONVEYED MATERIAL MAY BE TOWARD OR AWAY FROM DRIVE END.
PLEASE SPECIFY BEFORE ORDERING.

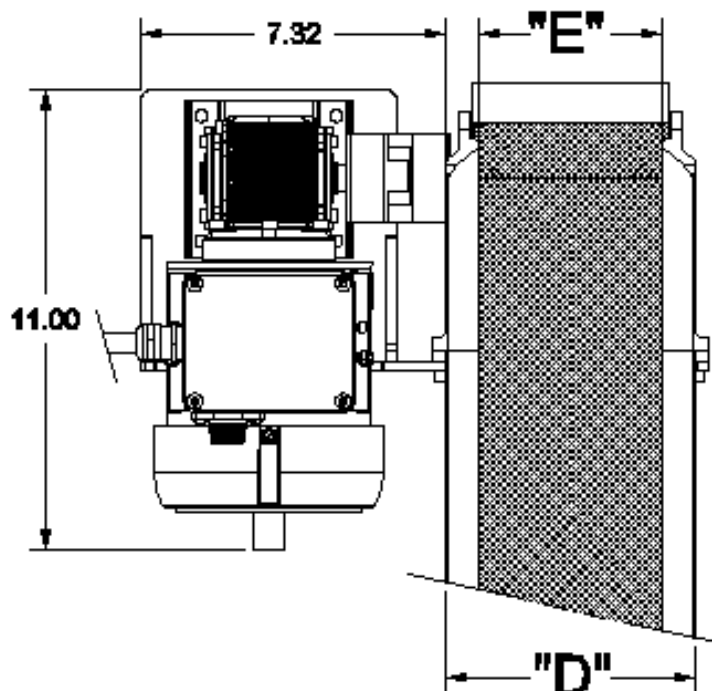

PAX RIGHT ANGLE CONVEYOR **With Flush Mount Tension End**

CONVEYOR LENGTH	A	B	C
4'	48"	55.06"	43.00"
5'	60"	67.06"	55.00"
6'	72"	79.06"	67.00"
7'	84"	91.06"	79.00"
8'	96"	103.06"	91.00"

CONVEYOR WIDTH	D	E
4"	3.95"	2.35"
5"	4.95"	3.35"
6"	5.95"	4.35"
7"	6.95"	5.35"
8"	7.95"	6.35"
9"	8.95"	7.35"
10"	9.95"	8.35"
11"	10.95"	9.35"
12"	11.95"	10.35"
14"	13.95"	12.35"
16"	15.95"	14.35"
18"	17.95"	16.35"
20"	19.95"	18.35"

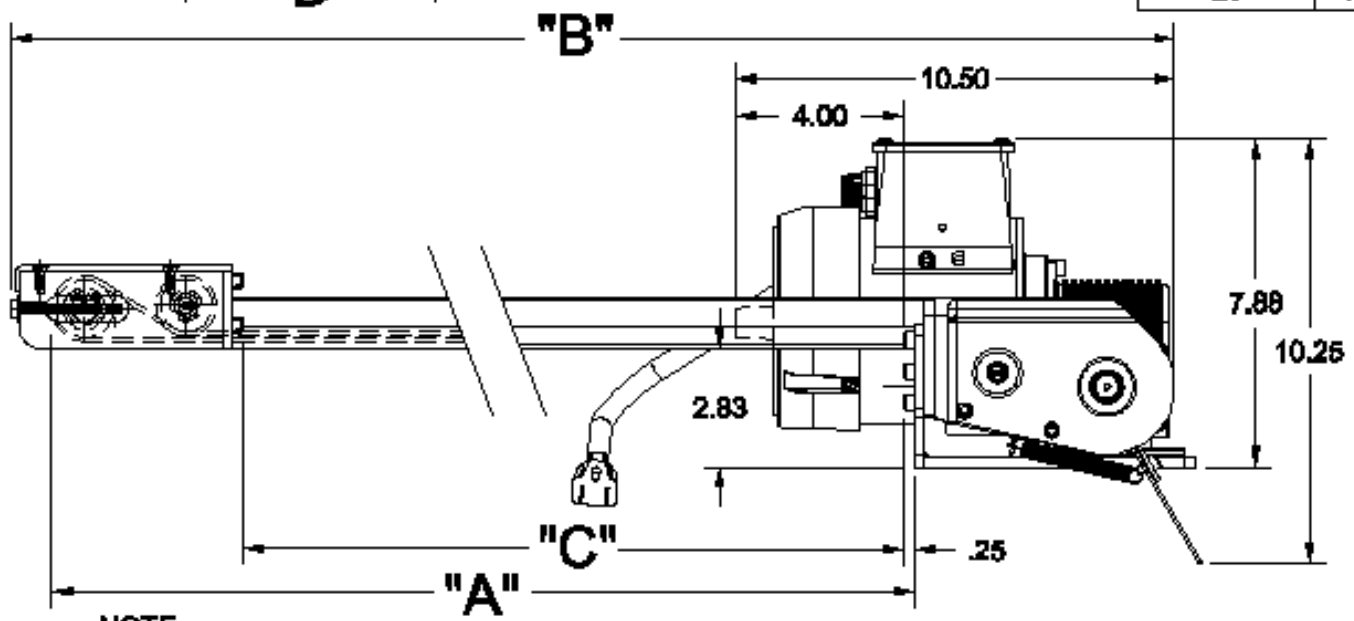

NOTE:
TRAVEL OF CONVEYED MATERIAL WILL BE TOWARDS DRIVE END.

Pax Low Profile Conveyors

- Extremely low profile
 - Only 3/8" from Bolster to top of Belt
 - Requires only 1.25" to 2.5" total clearance
- Built to survive a Stamping Environment
 - Resistant to Die Lube
 - Conveyor design protects and maximizes belt life.
 - Highly durable components.
 - Light weight modular design
- Pax Support & Customization

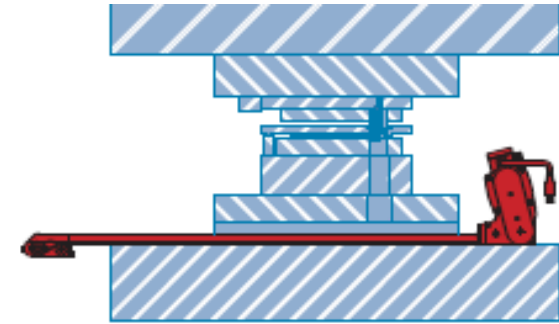

The Pax Low Profile Conveyor requires only 2-1/2" clearance between die and bolster.



Standard Drive



Inverted Drive



Extended Drive



Right Angle Drive