

TIMELINE

- ◆ In the summer of 2011 the previous shelter at City Park was discovered to be unsafe and needed to be torn down
- ◆ In the fall of 2011 the City of Philomath conducted a survey to find out what our citizens want in its place
- ◆ The plans and renderings in this brochure reflect those responses
- ◆ Steve Oien Construction has been hired to build the foundation
- ◆ The structure will be put out to bid once the foundation is complete
- ◆ **TOTAL PROJECT COST ESTIMATE:**
 - ◆ ~\$80,000
 - ◆ \$32,000 Raised to Date
 - ◆ Funds needed to complete- ~\$50,000

Anticipated Completion - July 2013

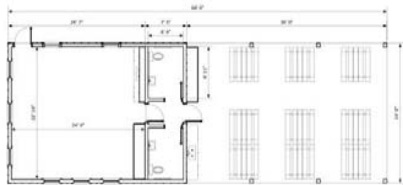

This project is a collaboration between all citizens and supporters of Philomath. The City of Philomath is coordinating, in partnership with the Philomath Community Foundation, the Lions Club and the Rotary Club of Philomath..

Tax-Deductible Donations Payable to:
Philomath Community Foundation
 c/o Rotary Club of Philomath
 PO Box 864
 Philomath, OR 97370

Contact Person— Josh Kvidt
Phone: (541) 766-2316
Fax: (541) 929-4258
E-mail: jkvi@citizensebank.com

City Park Shelter

*Shelter built by and built for the
City of Volunteers*



**SHELTER WILL BE LOCATED AT
 CITY PARK ON 23RD STREET,
 ONE BLOCK SOUTH OF
 APPLGATE**

BUILD A SHELTER IN CITY PARK

The Shelter will be rebuilt with indoor and outdoor meeting space.

The interior will be furnished with a sink and cabinets to accommodate small groups with onsite storage needs. Anticipated seating capacity is 40.

The outdoor space will have ample room for a summer BBQ, with covered seating for 54.



HOW TO GET INVOLVED

The easiest way to get involved is to simply "buy" a brick that will be included in the walkway around the Shelter. The bricks can be engraved with your name, or any other message you'd like. 4 x 8 bricks can have 2 lines of up to 14 characters per line. 8 x 8 bricks can have up to 3 lines.

4 x 8 brick- \$50.00



8 x 8 brick- \$100.00



Your Donation will be Tax-Deductible

For questions about these donations, please contact Josh Kvidt @ 541-766-2316 or jkvi@citizensEbank.com

There is also going to be an opportunity to get your hands dirty, whether it be through painting or using your green thumb.

Finally, donations for everything from lumber to landscaping supplies are appreciated. If you are interested in volunteering, contributing materials, would like a detailed materials list, or have other questions, please contact Dale Collins at 541-929-5090.

Thank you for your support!

This is Our chance to leave a lasting legacy in Our Park.

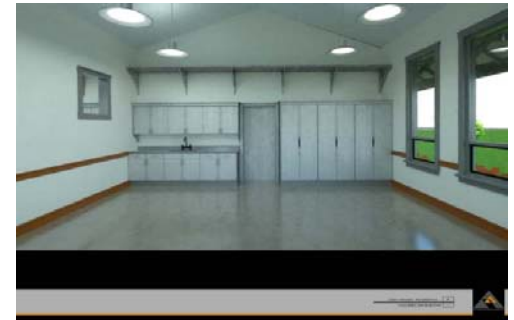

SHELTER WILL BE
LOCATED AT CITY PARK
ON 23RD STREET, ONE
BLOCK SOUTH OF
APPLEGATE

**Tax-Deductible Donations Payable to:
Philomath Community Foundation
c/o Rotary Club of Philomath
PO Box 864
Philomath, OR 97370**

**Contact Person- Josh Kvidt
Phone: (541) 766-2316
Fax: (541) 929-4258
E-mail: jkvi@citizensEbank.com**