

# 918 Clock Gauge & Tank Alarm

PEI at the NACS Show



918D & 918Q  
Available December 2012



Booth #4839

Morrison is expanding our tank alarm offerings! In addition to an updated single alarm box, we now offer **dual (D)** and **quad (Q)** alarm boxes.

Features

- Audible and visual indicators
- Self-powered by life-long replaceable lithium batteries
- Monitor up to four sensor signals
- User-defined alarm labels
- Visual alarm indicators easily identify which sensor is alarming
- Compatible with 918/918 TCP gauging equipment
- Low battery visual indicator
- Audible alarm sounds 90 dB alarm at four feet away
- Modular contacts make alarm devices easy to install
- UL 913 listed
- Corrosion-resistant and water-resistant housing for long life
- Intrinsically safe for Class I, Division 1 and 2, Group D hazardous location

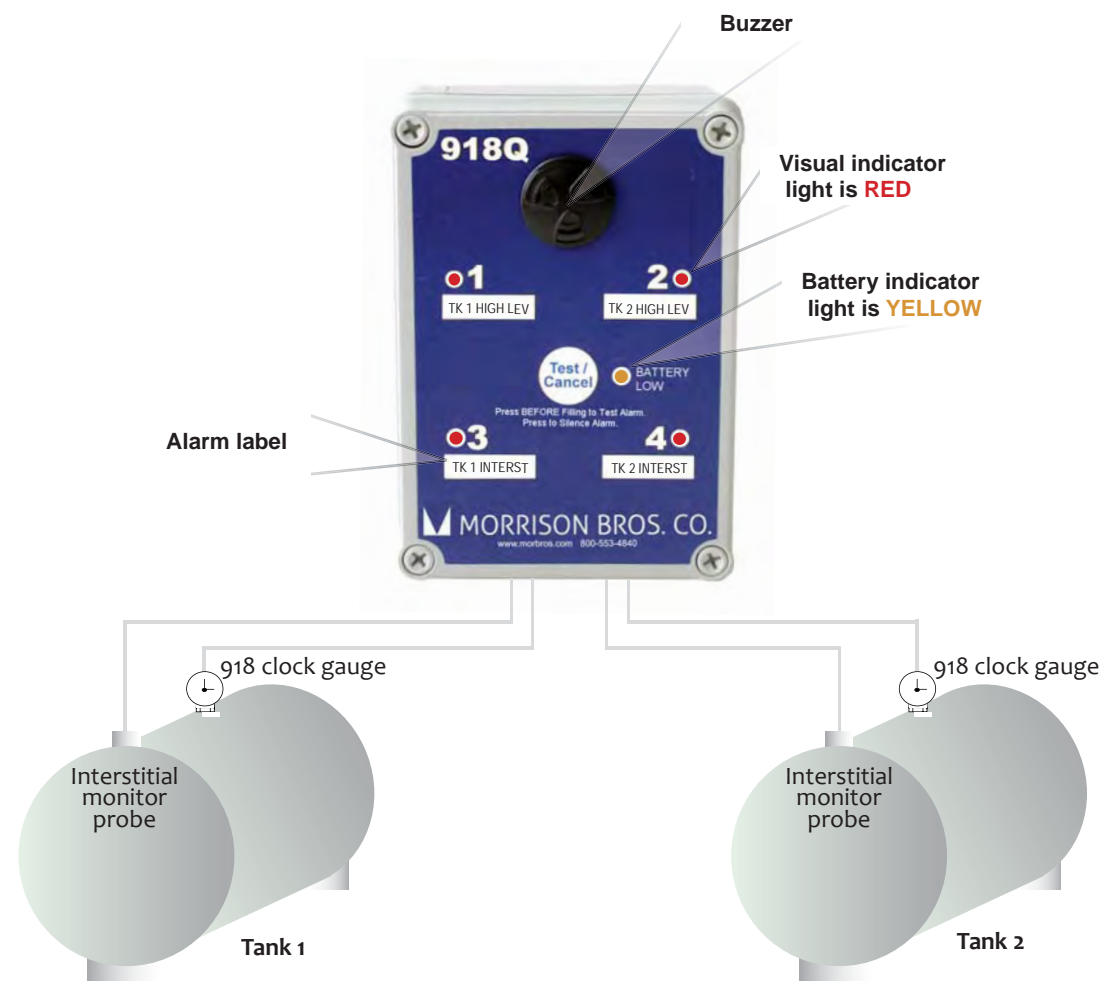

Morrison makes it easy to customize your alarm system!



Item Number	Description	Weight (lbs)
918---1000 AA	Single channel tank alarm box only	1.13
918D--1000 AA	Dual channel tank alarm box only	1.40
918Q--1000 AA	Quad channel tank alarm box only	1.40
918---0100 AG	2" Clock gauge single tank alarm with standard float	6.30
918---0400 AG	2" Clock gauge single tank alarm with drop tube float	6.30
918C--0100 AG	2" Gallon gauge single tank alarm with standard float *	6.30
918C--0400 AG	2" Gallon gauge single tank alarm with drop tube float *	6.30
918CF-0100 AG	2" Gallon gauge single tank alarm, female thread with standard float *	6.30
918CF-0400 AG	2" Gallon gauge single tank alarm, female thread with drop tube float *	6.30
918F--0100 AG	2" Clock gauge single tank alarm, female thread with standard float	6.30
918F--0400 AG	2" Clock gauge single tank alarm, female thread with drop tube float	6.30
918---0000AGEVR	2" Clock gauge less alarm, standard float, male threads, EVR	6.20
918---2000AGEVR	2" Clock gauge less alarm, drop tube float, male threads, EVR	6.20
918C--0000 AG	2" Gallon gauge less alarm, standard float, male threads	6.20
918C--2000 AG	2" Gallon gauge less alarm, drop tube float, male threads	6.20
918CF-0000 AG	2" Gallon gauge less alarm, standard float, female threads	6.20
918CF-2000 AG	2" Gallon gauge less alarm, drop tube float, female threads	6.20
918F--0000AGEVR	2" Clock gauge less alarm, standard float, female threads, EVR	6.20
918F--2000AGEVR	2" Clock gauge less alarm, drop tube float, female threads, EVR	6.20
918TCP0400 AS	2" Sensor assembly set at 5 feet	4.60
918TCP0500 AS	2" Sensor assembly set at 9.5 feet	4.60
918TCPS400 AS	2" Sensor assembly set at 5' with SS male thread adaptor & QD top	6.60
918TCPS500 AS	2" Sensor assembly set at 9.5' with SS male thread adaptor & QD top	6.60
918TCPS800 AS	2" Sensor assembly set at 5' with SS female thread adaptor & QD top	6.40
918TCPS900 AS	2" Sensor assembly set at 9.5' with SS female thread adaptor & QD top	6.40

Tank Alarms

Clock Gauge Tank Alarm Kits

Clock Gauges

Sensor Assemblies

\*Indicates a clock face must be ordered with this item.

Consult Price List for complete list including metric and BSP threaded options.



**MORRISON BROS. CO.**

570 E. 7th Street, P.O. Box 238 | Dubuque, IA 52004-0238

t. 563.583.5701 | 800.553.4840 | f. 563.583.5028

custserv@morbros.com | www.morbros.com